

North Shore Drive

recorded as (N88°19'53"E 2644.24') State Plane
N88°19'53"E 2644.18'
North Line of the Northeast 1/4 of Section 31-2-16.
(100')

North 1/4 Corner
Section 31-2-16
N. 220,423.26
E. 2,363,776.80

Witness Corner
Section 30-2-16
N. 220,501.80
E. 2,366,419.84
Northeast Corner
Section 31-2-16
N. 220,500.25
E. 2,366,419.88
N1°19'53"W
1.55'

Plat of Survey

of

Tax Parcel FCH 00032,

located in Government Lot 1 in the Northeast 1/4 of Section 31, Town 2
North, Range 16 East, Town of Delavan, Walworth County, Wisconsin.

Legal Description

A parcel of land described in a Trustee's Deed recorded May 15, 2017 as Document No.
946440, as shown below:

Lot 17, except the South 20 feet in Chicago Club Subdivision, Walworth County, Wisconsin.

Surveyed for: **Keefe Real Estate, Inc.**

416 Bauer Parkway
Delavan, Wisconsin. 53115



Bearings referenced to the North Line of the Northeast 1/4 of Section 31-2-16,
recorded as N88°19'53"E in the Wisconsin State Plane Coordinate System,
South Zone, (NAD-27).

Coordinates are referenced to the Wisconsin State
Plane Coordinate System, South Zone, (NAD-27).

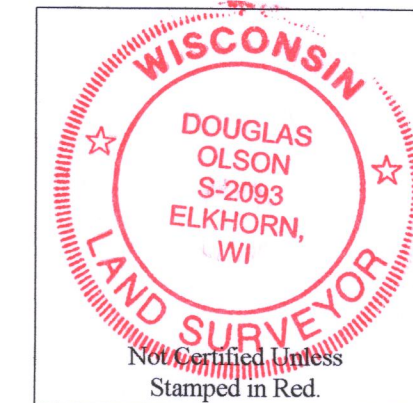

Notes:

- 1) This Plat of Survey is not certified unless signed and sealed in red ink.
- 2) This survey is subject to Wisconsin lien laws. This Plat of Survey is the notice of intent to file lien. Lien waiver required.
- 3) The Survey Date shown on this Plat of Survey is the completion date of the field work.



Copyright ©2019 by Olson Land Surveying, LLC.

All rights reserved. No part of this survey plat may be reproduced or transmitted in any form by any means - graphic, electronic, or mechanical, including photocopying, tracing, or information storage and retrieval systems - without permission in writing from Douglas G. Olson, Olson Land Surveying, LLC.

I hereby certify that I have surveyed the above described property in compliance with Chapter A-E 7 of the Wisconsin Administrative Code and that the map hereon is correct to the best of my professional knowledge and belief and shows the size and location of the property, its exterior boundaries, the location and dimensions of all visible structures thereon, boundary fences, apparent easements and roadways and visible encroachments, if any.

This survey is made for the exclusive use of the present owners of the property, and also those who purchase, mortgage or guarantee title thereto, within one year from the date hereof.

Douglas G. Olson
Wisconsin Professional Land Surveyor - 2093

Survey Date: May 28, 2019.
Revisions:

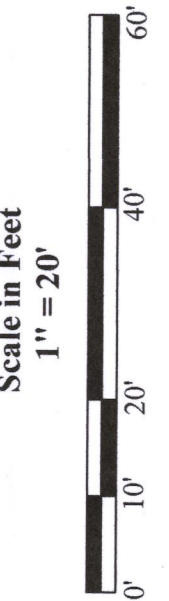

45 South Wisconsin Street | P.O. Box 322
Elkhorn, Wisconsin. 53121
Telephone: (262) 723-3434
Facsimile: (262) 723-8044
Email: doug@olsonsurveying.com
Website: www.olsonsurveying.com

OLSON
LAND SURVEYING, LLC
Rural | Residential | Commercial

Legend of Symbols & Abbreviations
N North
S South
E East
W West
Inches
Feet
Minutes
Degrees
Section Corner
Found Iron Rod
Found Iron Pipe
Found Iron Pipe, 1" dia.
Recorded Information
Utility Pedestal
Asphalt Surface
Concrete Surface
Brick Pavers or Stone

Found County Section Corner
Found Iron Rod
Found Iron Pipe
Found Iron Pipe, 1" dia.
Recorded Information
Utility Pedestal
Asphalt Surface
Concrete Surface
Brick Pavers or Stone

Sheet 1 of 1 Sheets
Drawing Name:
Job Reference Number
2019.064

2019.064

FCH-32

2110-5590

2110-5590